

PRODUCT INFORMATION PACKET

Model No: 5KCR46MN0055Y

Catalog No: E264

1/2 HP General Purpose Motor, 1 phase, 1800 RPM, 100-120/200-240 V, 56C Frame, TEFC
Single Phase TEFC Motors



Nameplate Specifications

| | | | |
|----------------------------|-----------------------------|------------------------|-------------------|
| Output HP | 0.50 Hp | Output KW | 0.37 kW |
| Frequency | 60 Hz | Voltage | 100-120/200-240 V |
| Current | 5.8-5.6,2.9-2.8 A | Speed | 1725/1425 rpm |
| Service Factor | 1.25 | Phase | 1 |
| Efficiency | 74 % | Power Factor | 0 |
| Duty | Continuous | Insulation Class | B |
| KVA Code | N | Frame | 56C |
| Enclosure | Totally Enclosed Fan Cooled | Thermal Protection | MAN |
| Ambient Temperature | 40 °C | Drive End Bearing Size | 6203 |
| Opp Drive End Bearing Size | 6203 | UL | Recognized |
| CSA | Yes | CE | N |

Technical Specifications

| | | | |
|--------------------|-------------------------------|-----------------------|----------------------------|
| Electrical Type | Capacitor Start Capacitor Run | Starting Method | SM |
| Poles | 4 | Rotation | Counterclockwise/Clockwise |
| Mounting | Rigid Base | Motor Orientation | ANY |
| Drive End Bearing | BALL | Opp Drive End Bearing | Ball |
| Frame Material | Rolled Steel | Overall Length | 11.83 in |
| Frame Length | 6.55 in | Shaft Diameter | 0.630 in |
| Shaft Extension | 1.88 in | | |
| Connection Drawing | 52A105383BA | Outline Drawing | 52A107739P1 |

This is an uncontrolled document once printed or downloaded and is subject to change without notice. Date Created:03/11/2020

THIRD ANGLE PROJECTION

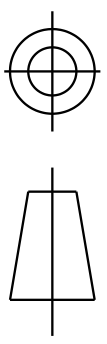

REVISIONS

| REV. | DESCRIPTION | DATE | APPROVED |
|------|---------------------------------|----------|----------|
| 9 | ADDED PT#8 PER PROD. IS11-5707 | 12/05/11 | KARTHIK |
| 10 | ADDED PT#9 PER SAMPLE DS12-5331 | 12/15/12 | RAJESH |

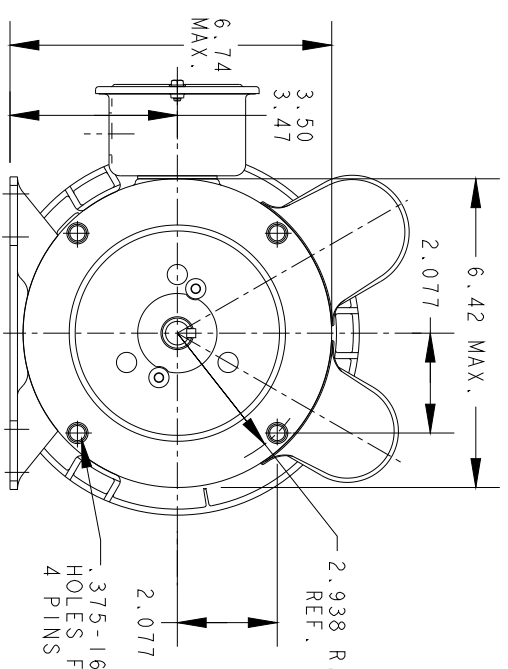
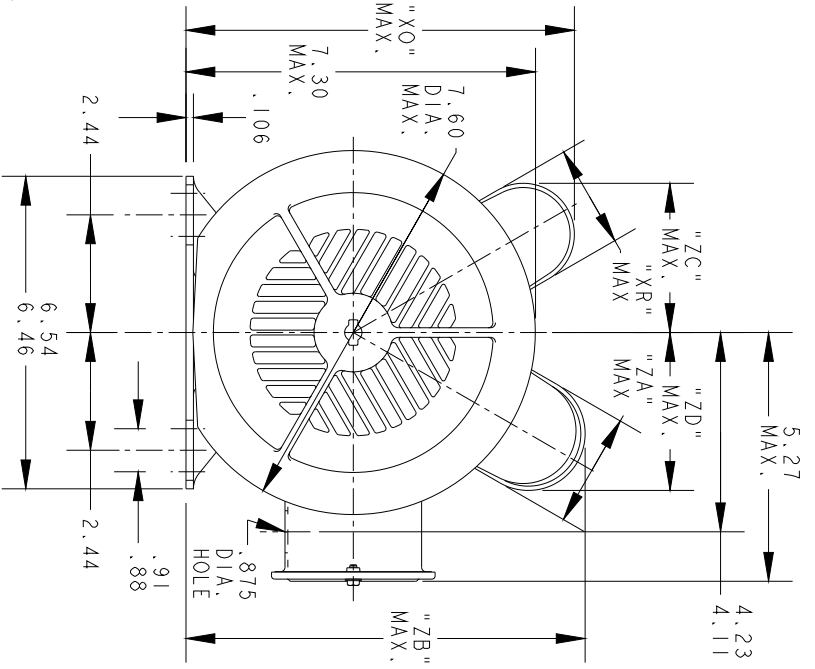

VIEW OF P. E. END SHIELD

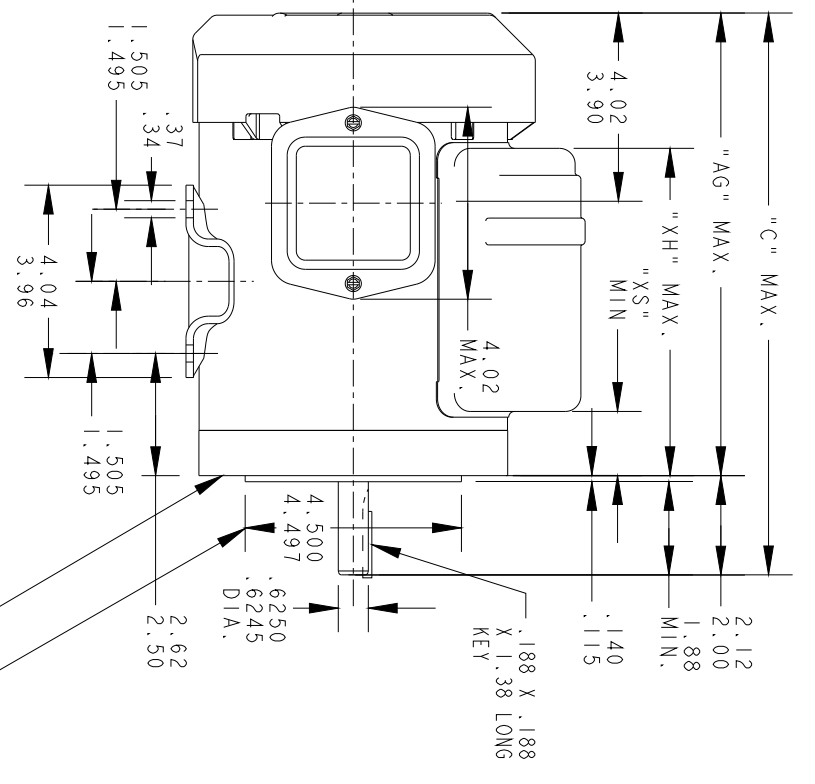

FACE RUNOUT (WITH INDICATOR MOUNTED STATIONARY, RELATIVE TO SHAFT) MUST NOT EXCEED .004 T.I.R.
 ECCENTRICITY OF THIS SURFACE (WITH INDICATOR MOUNTED STATIONARY, RELATIVE TO SHAFT) MUST NOT EXCEED .004 T.I.R.

ALL DIMENSIONS ARE IN INCHES

| SIGNATURES | | DATE |
|-------------------------------|--------------|-------------------|
| MODEL | M.D.PAPE | 10/15/91 |
| DETAIL | | |
| CHECKED | | |
| ENGRG | | |
| FOR ADDITIONAL INFO REFER TO: | MFG | |
| APPLIED PRACTICES | QUALITY | |
| DIMENSIONS ARE IN INCHES | ISSUED | M.D.PAPE 11/13/98 |
| MATERIAL | SOLID MODEL: | 52A107739 |



REGAL-BELOTT CORPORATION

OUTLINE

GENERAL PURPOSE MOTOR TEFC - BALL BEARING

- WELDED BASE R2 END MOUNTED FMF - 40 FRAME REDESIGN (SKCR46MM0055X)

| | | |
|---------------|----------|----|
| SCALE: 0.250 | REF. No: | |
| SIZE: DRAWING | A | |
| 52A107739 | REV | 10 |
| SHEET 1 of 2 | | |

THIRD ANGLE PROJECTION

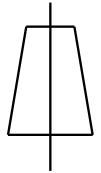
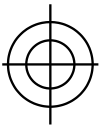

REVISIONS

| REV. | DESCRIPTION | DATE | APPROVED |
|------|---------------------------------|----------|----------|
| 9 | ADDED PT#8 PER PROD. IS11-5707 | 12/05/11 | KARTHIK |
| 10 | ADDED PT#9 PER SAMPLE DS12-5331 | 12/15/12 | RAJESH |

SHEET 2

REV 10

52A107739

DRAWING NO.

SIZE A

| | | | | | | | | | | | | | | |
|---|------|---------|----------|-------|-------|------|------|------|------|------|------|------|------|------------|
| 9 | KCR | 49 | 56CY | 12.97 | 10.85 | 7.50 | 8.33 | 2.33 | 1.98 | 2.33 | 8.14 | 3.30 | 3.60 | 7.68 |
| 8 | KCR | 49 | 56CY | 12.97 | 10.85 | 7.61 | 8.40 | 2.40 | 1.86 | 2.72 | 8.77 | 3.20 | 3.66 | 7.68 |
| 7 | KCR | 49 | 56C | 14.28 | 12.16 | 8.17 | 8.40 | 2.40 | 2.35 | 2.40 | 8.40 | 3.38 | 3.38 | 8.99 |
| 6 | KCR | 48 | 56C | 13.72 | 11.60 | 7.61 | 8.40 | 2.40 | 1.79 | 2.40 | 8.40 | 3.38 | 3.38 | 8.43 |
| 5 | KC | 49 | 56CY | 12.44 | 10.32 | 7.54 | 8.18 | 2.15 | 1.79 | 1.60 | 7.72 | 3.20 | 2.97 | 7.15 |
| 4 | KC | 46 | 56CY | 11.84 | 9.72 | 6.94 | 8.18 | 2.15 | 1.19 | 1.60 | 7.72 | 3.20 | 2.97 | 6.55 |
| 3 | KCR | 49 | 56CY | 12.97 | 10.85 | 7.61 | 8.18 | 2.15 | 1.86 | 2.72 | 8.77 | 3.20 | 3.66 | 7.68 |
| 2 | KCR | 49 | 56CY | 12.44 | 10.32 | 7.54 | 8.18 | 2.15 | 1.79 | 2.40 | 8.40 | 3.20 | 3.38 | 7.15 |
| 1 | KCR | 46 | 56CY | 11.84 | 9.72 | 6.94 | 8.18 | 2.15 | 1.19 | 2.40 | 8.40 | 3.20 | 3.38 | 6.55 |
| P | TYPE | GE SIZE | NEMA FR. | "C" | "AG" | "XH" | "XO" | "XR" | "XS" | "ZA" | "ZB" | "ZC" | "ZD" | MIN. SHELL |

SIGNATURES DATE

MODEL M.D.PAPE 10/15/91

DETAIL

CHECKED

ENGRG

FOR ADDITIONAL INFO REFER TO: MFG

APPLIED PRACTICES QUALITY

DIMENSIONS ARE IN INCHES ISSUED M.D.PAPE 11/13/98

MATERIAL SOLID MODEL: 52A107739



REGAL-BELOTT CORPORATION

TITLE

OUTLINE

GENERAL PURPOSE MOTOR TEFC - BALL BEARING

WELDED BASE R2 END MOUNTED FMF - 40 FRAME REDESIGN (5KCR46MM0055X)

SIZE DRAWING A

52A107739

REV 10

SCALE: 0.250 REF. No:

SHEET 2 of 2

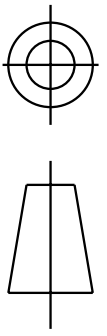

| REV. | DESCRIPTION | DATE | APPROVED |
|------|----------------|----------|----------|
| 7 | UPDATED FORMAT | 01/05/06 | MAM |

CCW/CW ROTATION - DUAL VOLTAGE
TYPE KC, KH OR KCR - WITH THERMAL PROTECTOR

CAPACITOR AS SHOWN FOR KC MOTORS ONLY. LEAD T5 BLACK CONNECTED DIRECTLY TO TERMINAL BOARD FOR KH MOTORS.

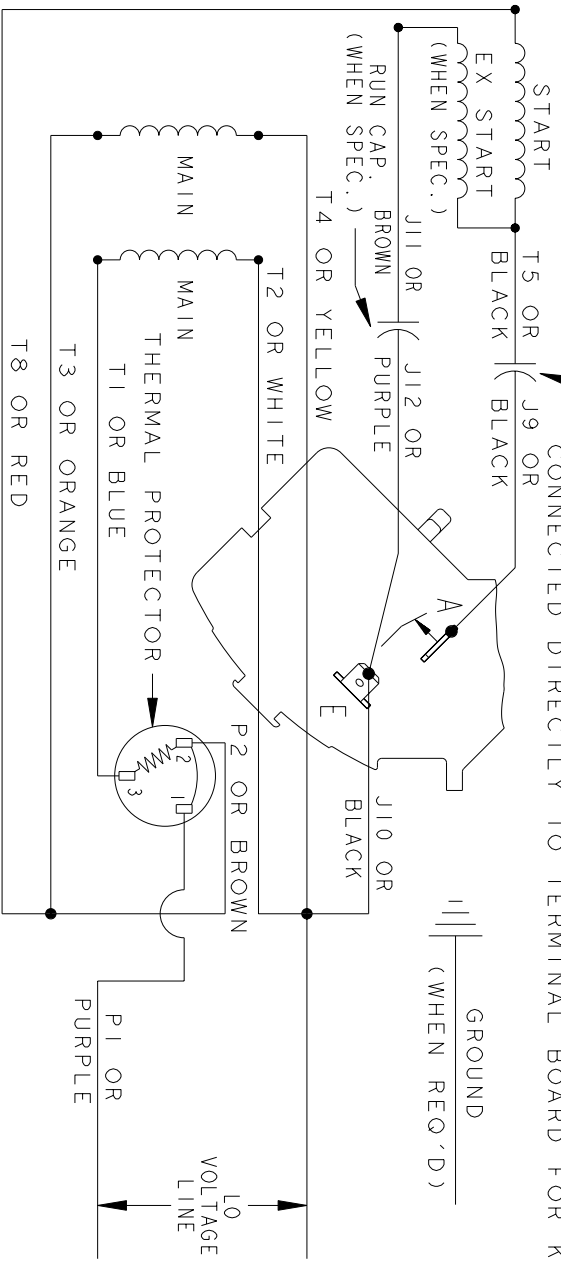

CAPACITOR AS SHOWN FOR KC MOTORS ONLY. LEAD T5 BLACK CONNECTED DIRECTLY TO TERMINAL BOARD FOR KH MOTORS.

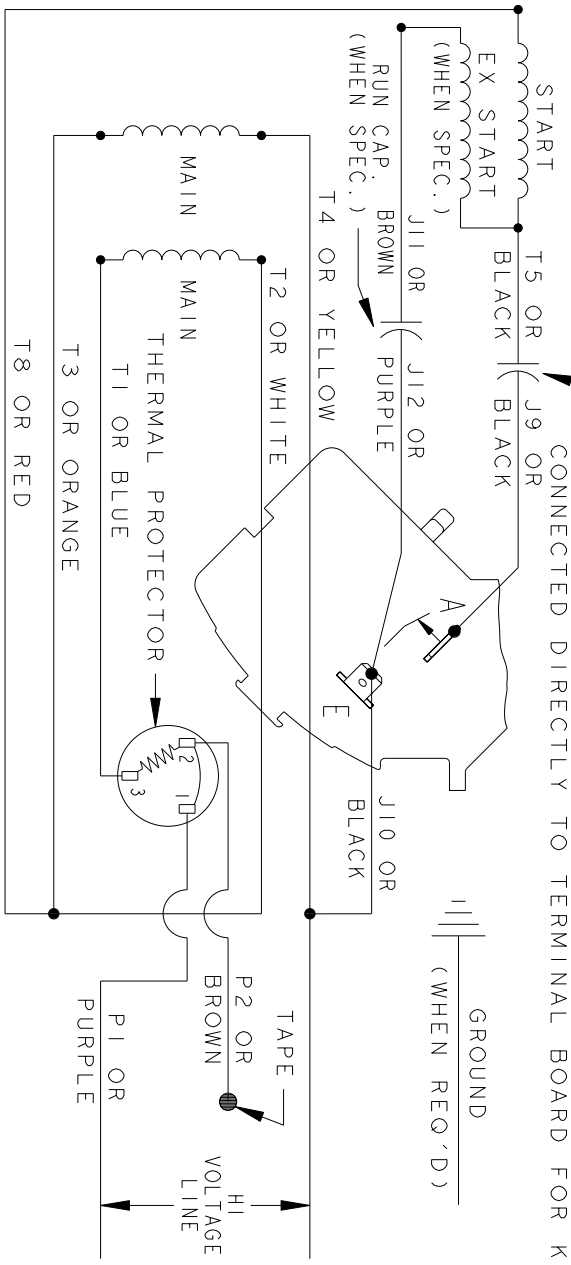

NOTE#1 - TO REVERSE ROTATION, INTERCHANGE T8 RED AND J10 BLACK LEADS.
NOTE#2 - WHEN MORE THAN ONE CAPACITOR IS USED, CONNECT IN PARALLEL.
NOTE#3 - 115D958ABP5 - HIGH CURRENT CONTACTS.

SWITCH (C) - 115D958ABP5, SWITCH (H) - 115D958AA (USE 115D958DA FOR EP)

REF. DIAG. - 113A327, 119A9352 & 52A102102 CONNECTION LABEL - 52X332912

| SIGNATURES | | DATE |
|--------------------------|--------------------------|----------|
| MODEL | M.D.P. | 06/29/87 |
| DETAIL | | |
| CHECKED | | |
| ENGRG | | |
| MFG | | |
| QUALITY | | |
| ISSUED | M.D.P. | 12/11/97 |
| APPLIED PRACTICES | | |
| DIMENSIONS ARE IN INCHES | | |
| MATERIAL | SOLID MODEL: 52A105383BA | |



REGAL-BELOTT CORPORATION

CONNECTION DIAGRAM

FME: 30 FRAME SWITCH REDESIGN

52A105383BA

| | | |
|--------------|-----------|--------------|
| SCALE: 1.000 | REF. No.: | SHEET 1 of 1 |
|--------------|-----------|--------------|